



Higashi Ward Recyclables

We collect recyclable garbage at recycle boxes located at nine public facilities in Fukuoka City, as well as local community collection boxes and local community group collections (such as used paper collections by children's clubs and local communities), or shopfront collections at supermarkets, electronics stores and other stores. Collection locations differ depending on the item. Check the website for your closest collection location.

Information on Garbage Separation and Recycling

<http://kateigomi-bunbetsu.city.fukuoka.lg.jp/en/>

Search for information on recycle stations and separating garbage



Used paper

Collection locations

Recycle boxes at public facilities, local community collection stations or community group collections.

Separate used paper into the three types below and bind the piles crosswise with twine.

Newspapers

(Leave advertisements inside.)

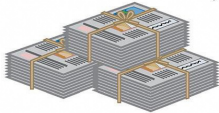

Cardboard



Cardboard that is corrugated inside

Paper waste (magazines and other paper)



Paper sweet boxes

Wrapping paper



What is paper waste

Recyclable paper items not including newspapers and cardboard boxes, such as sweet boxes and envelopes

OK

Paper Waste

- Paper sweet boxes, etc.
- Tissue boxes
- Books and school printouts
- Cling film tubes and toilet paper tubes
- Flyers
- Envelopes
- Postcards
- Pamphlets
- Books
- Paper bags
- Magazines

You can recycle paper regardless of its thickness or size. You can even recycle small price tags.

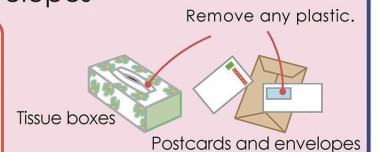

NG

Items that cannot be disposed of as paper waste

- Plastic coated paper
- Thermal paper (such as fax paper and receipts)
- Carbon paper (such as shipping labels)
- Scented paper (such as packaging for washing powder and incense)
- Oily paper (such as pizza boxes or paper with crayon on)
- Photographs

Separate newspapers and cardboard boxes from other paper waste and tie them into individual piles.

If any vinyl is visible when you slowly tear the paper, you cannot recycle it.



Disposing of Paper Waste in 3 steps

Step ① Collect paper waste in paper bags.

Any paper bag* is acceptable.

Use any paper bag* you have in your home.

*Be sure to remove any fabric or plastic handles.



Step ② Close the paper bag.

Be sure the paper doesn't fall out when it's collected.

Tie with string or staple together.

You can also just tie magazines together with a cross.

Don't use sticky tape.



Step ③ Take the waste to used paper local community group collections or recycle stations.

You can also take it to recycle stations just like newspapers and cardboard boxes.

△This process is not the same as regular garbage collections. You cannot dispose of them at your apartment complex designated waste area.



Used Paper Collection Stations



QR Translator

- 日本語
- English
- 中文(简体)
- 한국어
- 中文(繁體)
- Tiếng Việt
- ภาษาไทย
- தமிழ் மொழி
- Tagalog
- සිංහල
- Bahasa Indonesia